

# Royal 102" Wide body featuring triple slide-outs

**III MODELS HAVE SLOPING ROOF LINES**

**XT3 MODELS HAVE STRAIGHT ROOF LINES**



**38' RL SAN DIEGO III ROYAL**



**40' FL LAS VEGAS III ROYAL**



**38' RL MIAMI XT3 ROYAL (SIDE AISLE)**



**40' RL SAN GABRIEL III ROYAL**



**38' RL PASADENA XT3 ROYAL**



**38' RK MONTEREY XT3 ROYAL (SIDE AISLE)**



**40' RL AUGUSTA III ROYAL**

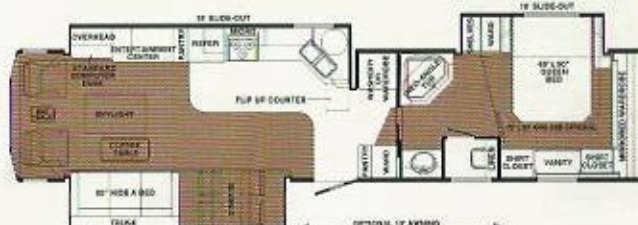

**40' RL KINGMAN XT3 ROYAL**



**40' RK TUCSON XT3 ROYAL**

All Tetons® offer triple slide-outs, vacu-bond hard wall sidewalls, vented attic, 7" roof with R-25 insulation factor, ducted air conditioning and dual ducted furnaces with 62,000 BTUs of heat on all but Phoenix models.

Teton Homes® is pioneering the XT3 models which includes the kitchen in the slide-out allowing us to enlarge the living area to maximize your living area.